

FOR SALE

502 E Haley St, Santa Barbara

Downtown Industrial/Retail Building on High-Traffic Corner | 5,214 SF



Experience. Integrity. Trust.
Since 1993

Dylan Ward
805.898.4392
dylan@hayescommercial.com
lic. 01472452

Francois DeJohn
805.898.4365
fran@hayescommercial.com
lic. 01144570



PROPERTY SUMMARY

On a prominent, high-visibility corner in the Laguna District, this industrial/retail building is perfectly positioned along the Haley corridor between the two main retail arteries in town: State and Milpas streets. Given the flexible, open layout and proximity to local hot spots, there is winery/ brewery potential for an owner-user. Alternately, the property could easily be transformed into the next high-profile creative office space, with numerous tech startups and amenities nearby. Recent improvements include a new roof and sewer lateral.

Price:	\$2,950,000
Building Size:	Ground floor 4,594 SF Mezzanine 620 SF Total 5,214 SF
Lot Size:	5,227 SF
APN:	031-291-001
Zoning:	C-M (Commercial/ Manufacturing)
Occupancy:	Vacant
Roll-Up Doors:	Four, ground-level
Ceiling Height:	13', up to 20' to underside of pitched roof
Restrooms:	One, private
Showings:	CLA



Experience. Integrity. Trust.
Since 1993

Dylan Ward
805.898.4392
dylan@hayescommercial.com
lic. 01472452

Francois DeJohn
805.898.4365
fran@hayescommercial.com
lic. 01144570





Office Area



Updated Glass Doors



Spacious Layout



Mezzanine

Experience. Integrity. Trust.
Since 1993

Dylan Ward
805.898.4392
dylan@hayescommercial.com
lic. 01472452

Francois DeJohn
805.898.4365
fran@hayescommercial.com
lic. 01144570



FLOOR PLAN

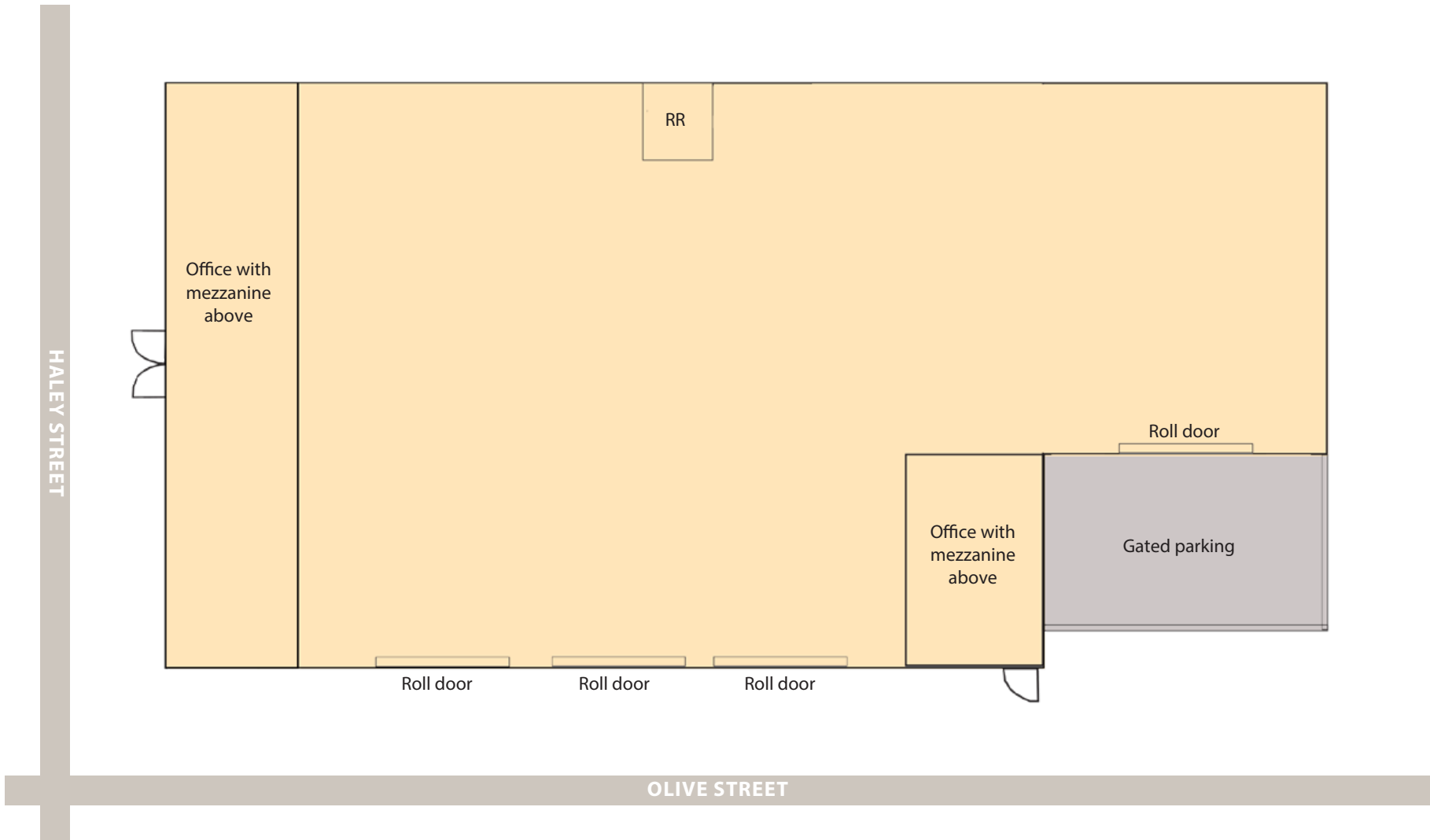

Experience. Integrity. Trust.
Since 1993

Dylan Ward
805.898.4392
dylan@hayescommercial.com
lic. 01472452

Francois DeJohn
805.898.4365
fran@hayescommercial.com
lic. 01144570





LAGUNA DISTRICT

Adaptive-Reuse & Creative-Industrial



The Laguna District is Santa Barbara’s rising creative-industrial hub just east of downtown, centered on Haley, Gutierrez, and Montecito Streets. Mixing adaptive-reuse warehouses with breweries, design studios, and specialty retailers, it delivers an energetic “working Santa Barbara” vibe minutes from State Street and the Waterfront. Highlights include The Mill, a historic feed mill reborn as an artisan marketplace with winery, brewery, restaurant, and studios, and The Platform, a modern multi-tenant creative campus offering flexible spaces for offices, showrooms, and makers. Often called the Haley Corridor, this nine-block stretch attracts tenants with authentic character, strong daytime traffic, and a growing reputation—ideal for showroom, production, creative office, and food & beverage concepts seeking a high-identity address without State Street formality.

WALKSCORE
95

'Walker's Paradise'
Daily errands do not require a car

MEDIAN HOUSEHOLD INCOME
(3 mi radius)

\$103,709

AREA POPULATION
(3 mi radius)

81,953

Source: esri. 2025 demographics centered on 406 E Haley Street



Experience. Integrity. Trust.
Since 1993

Dylan Ward
805.898.4392
dylan@hayescommercial.com
lic. 011472452

Francois DeJohn
805.898.4365
fran@hayescommercial.com
lic. 01144570





Experience. Integrity. Trust.
Since 1993

Dylan Ward
805.898.4392
dylan@hayescommercial.com
lic. 01472452

Francois DeJohn
805.898.4365
fran@hayescommercial.com
lic. 01144570

