

FOR LEASE

26 Castilian Drive, Goleta
Office Space: 9,841-34,631 SF

PRICE
REDUCTION



 **Hayes**
COMMERCIAL GROUP

Stephen Hayes
805-898-4370
steve@hayescommercial.com
lic. 00827640

Francois DeJohn
805-898-4365
fran@hayescommercial.com
lic. 01144570

Kristopher Roth
805-898-4361
kris@hayescommercial.com
lic. 01482732

FOR LEASE

26 Castilian Drive, Goleta
Office Space: 9,841-34,631 SF



Available:	Immediately			
Square Feet:	<u>Suite</u>	<u>Size</u>	<u>Floor</u>	<u>Type</u>
	A	24,790 SF	1st & 2nd	Office
	B	9,841 SF	1st	Office
	Total	24,631 SF		
Total Building Size:	75,237 SF			
Rental Rate:	\$1.25 NNN (.31)			
Utilities:	Tenant to pay pro-rata share of all utilities			
Term:	5-10 years			
Zoning:	MR-P			
Parking:	3.3 / 1,000 SF			
Elevator:	Yes, two			
HVAC:	Yes			
Restroom:	Suite B has common restrooms with showers. Suite A has three sets of restrooms.			
Sprinklers:	Yes			
Signage:	Prominent building and monument signage available			
Location:	Great proximity to US 101, UCSB and the Santa Barbara Airport.			

The information contained herein has been obtained from the owner of the property or from other sources deemed reliable. We have no reason to doubt its accuracy, but we do not guarantee it.



Stephen Hayes
805-898-4370
steve@hayescommercial.com
lic. 00827640

Francois DeJohn
805-898-4365
fran@hayescommercial.com
lic. 01144570

Kristopher Roth
805-898-4361
kris@hayescommercial.com
lic. 01482732

FOR LEASE

26 Castilian Drive, Goleta
Office Space: 9,841-34,631 SF

Floor Plans

First Floor

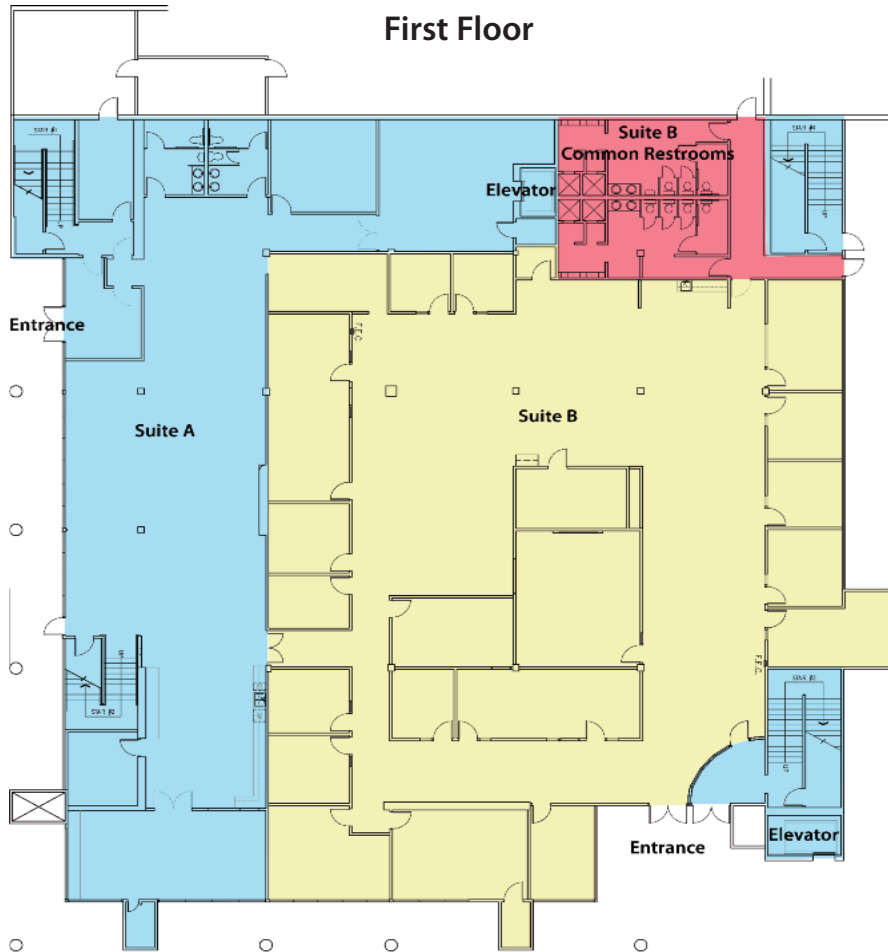

Second Floor



FOR LEASE

26 Castilian Drive, Goleta
Office Space: 9,841-34,631 SF



 **Hayes**
COMMERCIAL GROUP

Stephen Hayes
805-898-4370
steve@hayescommercial.com
lic. 00827640

Francois DeJohn
805-898-4365
fran@hayescommercial.com
lic. 01144570

Kristopher Roth
805-898-4361
kris@hayescommercial.com
lic. 01482732