

FOR LEASE

139 N. Fairview Avenue, Goleta
Office/Retail Space: 927 SF



 **Hayes**
COMMERCIAL GROUP

Kristopher Roth
805-898-4361
kris@hayescommercial.com
lic. 01482732

Michael Martz, CCIM
805-898-4363
michael@hayescommercial.com
lic. 01391838

FOR LEASE

139 N. Fairview Avenue, Goleta
Office/Retail Space: 927 SF

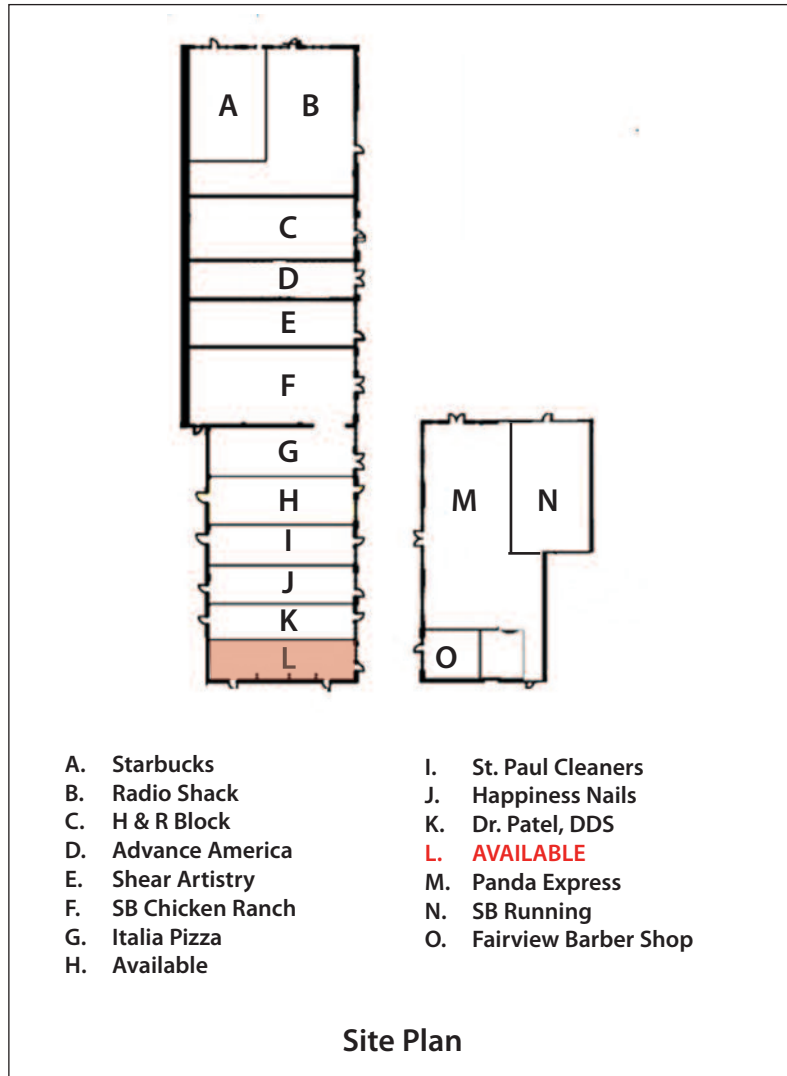

Square Feet: 927 SF (approx.)

Rental Rate: \$1.35 NNN (.34)

Available: March 1, 2012

Parking: 4/1,000 SF

Zoning: C-2

Term: 3 - 5 years

Traffic Count: 81,000 ADT

Showings: Call Listing Agents

Major Tenants: OSH, Vons, Michael's, Rite Aid, Bed, Bath & Beyond, Santa Barbara Chicken Ranch, Panda Express, Starbucks

Comments: This efficient space is perfect for many uses including office, service retail and general retail. The Fairview Center, anchored by OSH, Vons, Michael's, Rite Aid and Bed, Bath & Beyond, is one of the Santa Barbara area's premier retail centers.

FOR LEASE

139 N. Fairview Avenue, Goleta
Office/Retail Space: 927 SF

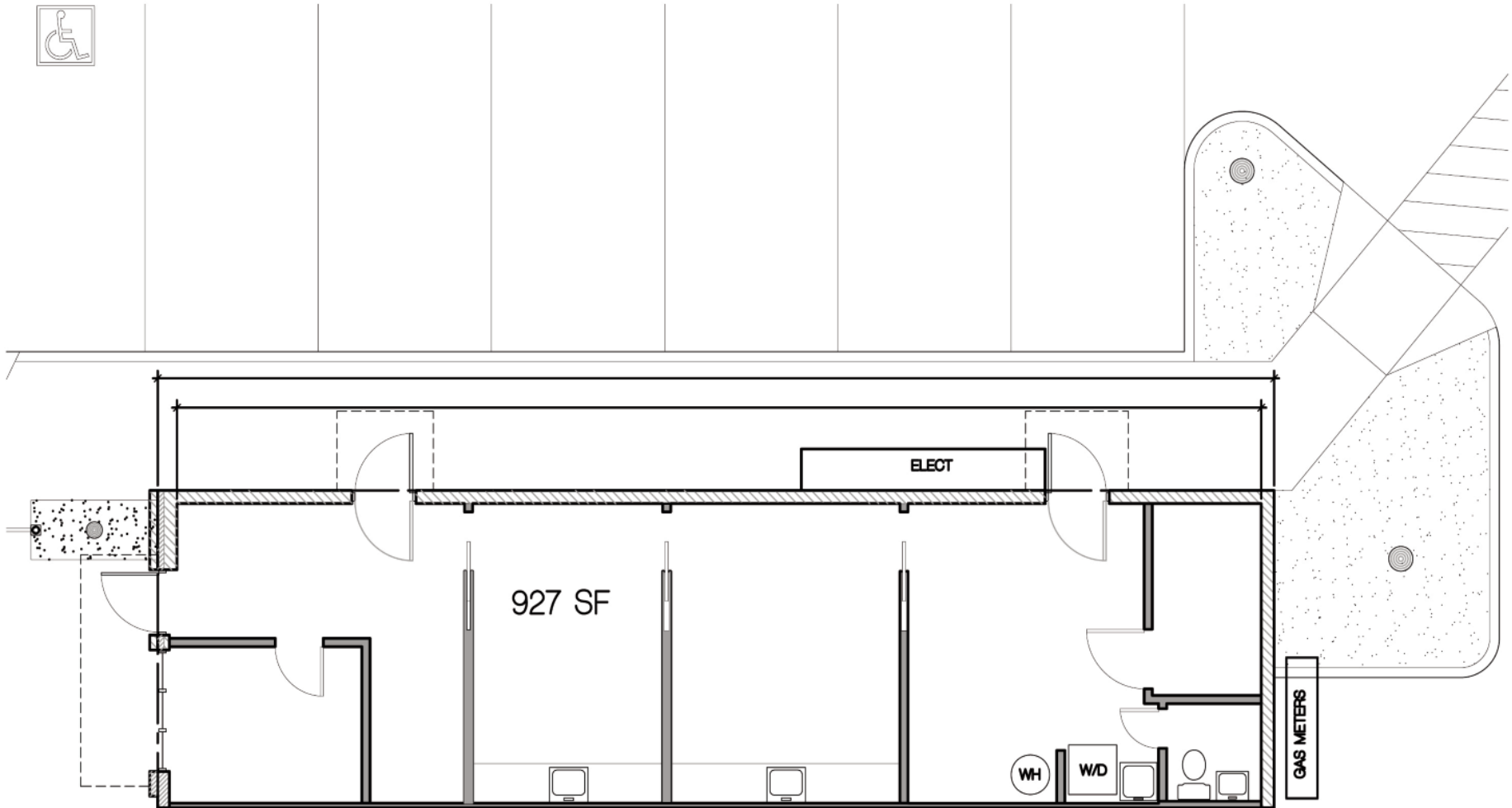

Floor Plan



Kristopher Roth
805-898-4361
kris@hayescommercial.com
lic. 01482732

Michael Martz, CCIM
805-898-4363
michael@hayescommercial.com
lic. 01391838

FOR LEASE

139 N. Fairview Avenue, Goleta
Office/Retail Space: 927 SF



Aerial

The information contained herein has been obtained from the owner of the property or from other sources deemed reliable. We have no reason to doubt its accuracy, but we do not guarantee it.



Kristopher Roth
805-898-4361
kris@hayescommercial.com
lic. 01482732

Michael Martz, CCIM
805-898-4363
michael@hayescommercial.com
lic. 01391838